

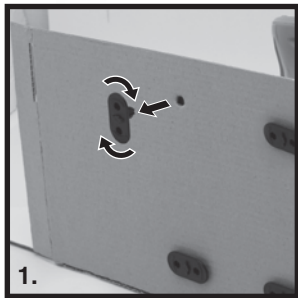

# Bubble Fantasia™ Instruction Sheet

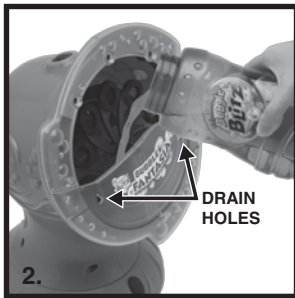

1. Separate Bubble Fantasia™ from package by twisting the four plastic locks on bottom clockwise. Discard locks. Install batteries (see instructions on right)



2. Remove cap and seal from your Bubble Fantasia™ bottle. Pour solution slowly into front opening, until level reaches just below drain holes on front panel. **DO NOT OVERFILL.**

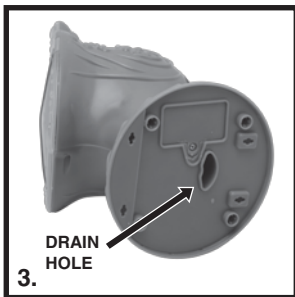

3. If bubble solution accidentally spills into the machine, it will come out through bottom drain hole - this is normal!

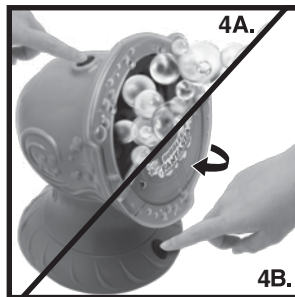

4A. Press on/off button on top of Bubble Fantasia™. Lights will light up and bubbles will start blowing. 4B. Press button on base of machine to start 360° spinning action. Press again to stop. Add more solution as needed.

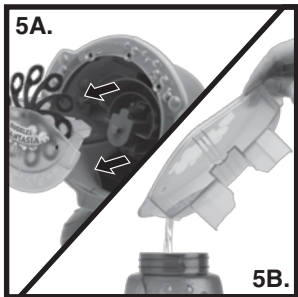

5A. When finished using your Bubble Fantasia™, pull out the tray. 5B. Remove the wands and pour any excess solution back into the bottle. Rinse the tray and wands with plain water. Towel dry.

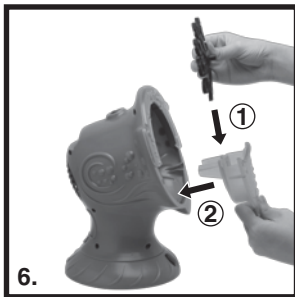

To replace wand tray back: 1. Insert wand into tray. 2. Slide tray into machine, making sure that the wand attaches to square post.

## BATTERY INSTALLATION & REPLACEMENT

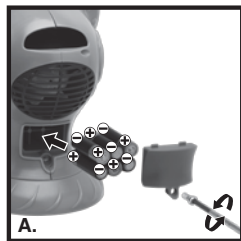

A. Remove screw and battery compartment cover on back of the machine. Install 6 AA Alkaline batteries. Replace battery compartment cover and screw to close.

**WARNING:**  
Replacement of batteries should be done by an adult. Do not mix old batteries and new batteries. Do not mix alkaline, standard or rechargeable batteries. Do not dispose of batteries in fire, batteries may explode or leak. Do not attempt to open battery outer casing.

**TO INSTALL, REMOVE OR REPLACE BATTERIES:** Remove screw and battery compartment cover and install, remove or replace 6 AA BATTERIES following the position indicated. Replace the battery compartment cover and screw.

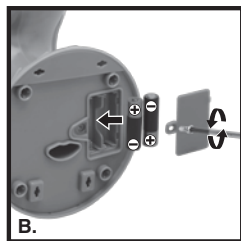

B. Remove screw and battery compartment cover on bottom of the machine. Install 2 AA Alkaline batteries. Replace battery compartment cover and screw to close.

To ensure best performance, install fresh AA Alkaline batteries.

**ITEM WILL NOT WORK IF BATTERIES ARE INSERTED INCORRECTLY. IF ITEM DOES NOT WORK, REVERSE BATTERY DIRECTION AND TRY AGAIN.**

**WARNING:**  
Replacement of batteries should be done by an adult. Do not mix old batteries and new batteries. Do not mix alkaline, standard or rechargeable batteries. Do not dispose of batteries in fire, batteries may explode or leak. Do not attempt to open battery outer casing.

**TO INSTALL, REMOVE OR REPLACE BATTERIES:** Remove screw and battery compartment cover and install, remove or replace 2 AA BATTERIES following the position indicated. Replace the battery compartment cover and screw.

ADULT ASSEMBLY IS REQUIRED - THERE ARE SMALL PARTS BEFORE ASSEMBLY. PLEASE KEEP AWAY FROM CHILDREN BEFORE ASSEMBLY.

## HELPFUL BUBBLE FANTASIA™ HINTS!

1. Be patient; for tons of bubbles you must allow time for solution to fully coat the bubble wands.
2. To ensure best performance, always make sure to replace batteries with fresh AA Alkaline batteries at the first sign of wear.
3. Bubble Fantasia™ will produce bubbles and lights in either spinning mode or stand-still mode!
4. Bubble Fantasia™ works best with Bubble Blitz™ solution.
5. Make sure you always have enough Bubble Blitz™ solution at hand!